



ROOFING & WALLING PRODUCTS

Pierce-Fastened Roof System



www.ajiya.com

JET RIB

Industrial Profile Metal Roofing



SECTIONAL PROFILE



- Roll - forming long length high tensile metal decking.
- Manufactured from high tensile steel substrate protected with corrosion inhibitive treatment.
- Roofing and walling profiles with material warranty up to 25 years. *(Warranty terms & conditions apply)*
- With effective cover width of 720mm and rib height of 23mm.
- Recommended minimum roof pitch is 3°.
- Innovative, durable and cost effective.
- Widely used for commercial and industrial projects such as factories, condominium, cabin, hoarding, cladding and etc.

Dimensions

Rib height : 23mm ±1mm
 Effective cover : 720mm
 Minimum roof pitch : 3°

Tolerance

Thickness for material : ±0.03mm
 Effective Width : ±5mm
 Finishing Length : ±5mm

METHOD OF INSTALLATION (APPLICABLE FOR AP RIB, JET RIB, MEGA RIB 30/35, CLS 705, CL 710)

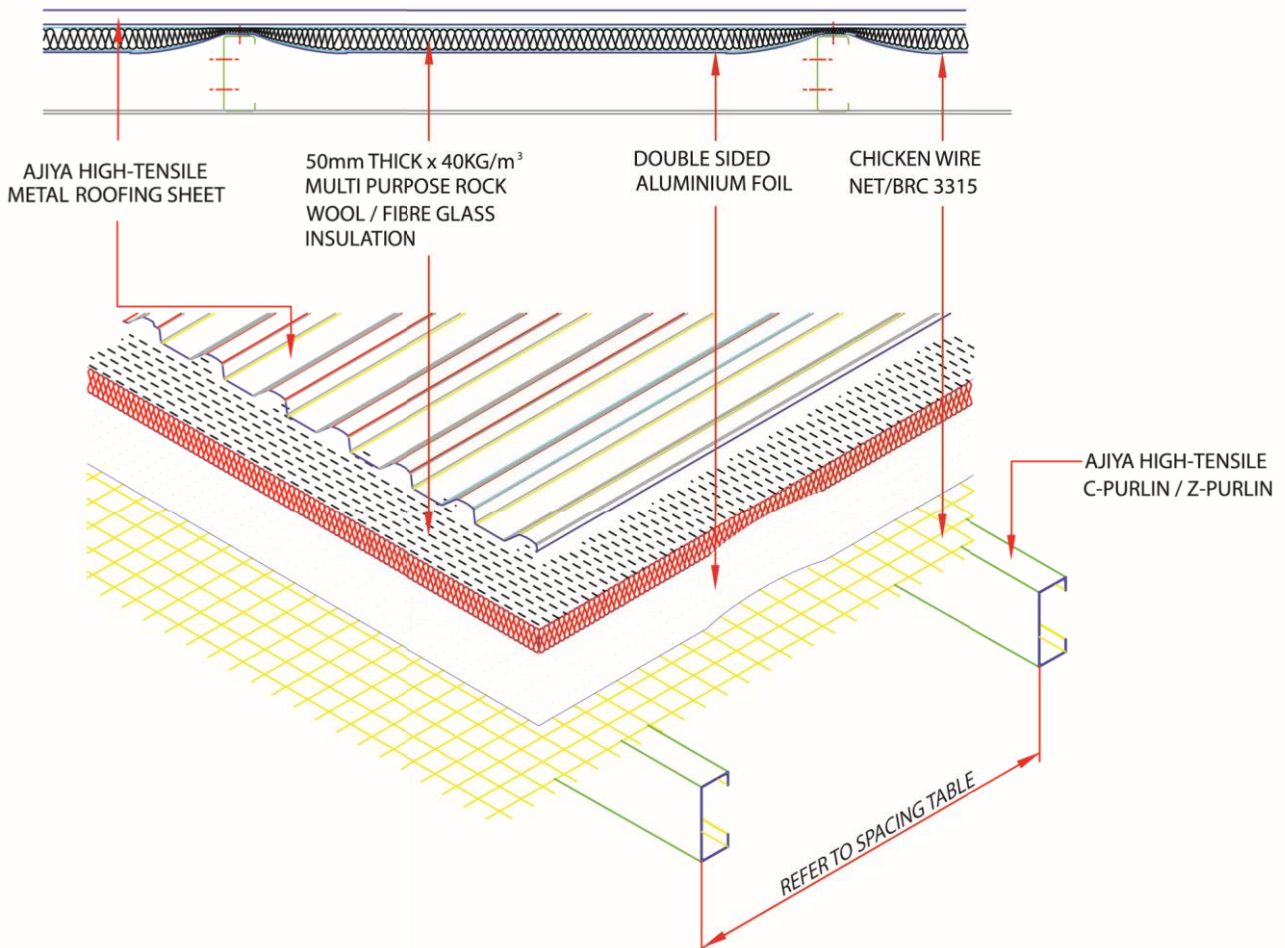

JET RIB	AVAILABLE THICKNESS ***						
	Base Metal Thickness (mm)	Total Coated Thickness (mm)	* Weight per meter (kg/m)	* Weight per sq meter (kg/m ²)	* Coverage per ton (m ² /MT)	Steel Grade	Minimum Yield Strength (MPa)
	0.35	0.40	2.65	3.68	271	JIS3312[MS2383] / AS1397 [MS1196]	550
	0.40	0.46	3.01	4.18	239	JIS3312[MS2383] / AS1397 [MS1196]	550
	0.42	0.48	3.15	4.38	228	JIS3312[MS2383] / AS1397 [MS1196]	550
0.48**	0.53	3.58	4.97	201	JIS3312[MS2383] / AS1397 [MS1196]	550	

- Total Coated Thickness (TCT) depends on Coating Mass. Please contact our technical department for advice, or, other thickness.

* Weight shown above is depending on material used.

** 0.48mm: Depends on material availability.

JET RIB	DISTRIBUTED LOAD CAPACITY – CONTINUOUS SPAN CONDITION ***											
	Thickness (mm) [BMT]	SPAN	mm	900	1050	1200	1350	1500	1650	1800	1950	2100
	0.35	Serviceability	kN/m ²	2.61	2.18	1.58	1.18	0.93	0.63	0.48	0.33	0.28
		Strength		4.16	3.47	2.51	1.87	1.47	0.99	0.75	0.51	0.43
	0.40	Serviceability		2.73	2.33	1.73	1.33	1.08	0.78	0.54	0.43	0.30
Strength		4.35		3.71	2.75	2.11	1.71	1.23	0.83	0.67	0.47	
0.42	Serviceability	2.85		2.45	1.85	1.45	1.20	0.90	0.65	0.48	0.33	
	Strength	4.55		3.91	2.95	2.31	1.91	1.43	1.03	0.76	0.52	
0.48	Serviceability	2.95		2.64	2.09	1.74	1.49	1.29	1.04	0.84	0.54	
	Strength	4.70		4.20	3.32	2.76	2.36	2.04	1.64	1.32	0.84	

- Based on dead load 0.1kN/m², Live load 0.25kN/m² & wind load 0.75kN/m².

- Deflection Limit: SPAN/180.

JET RIB	RECOMMENDED MAXIMUM SPACING OF SUPPORTS ***					
	Base Metal Thickness (mm)	Total Coated Thickness (mm)	ROOF		WALL	
			End Span (mm)	Internal Span (mm)	End Span (mm)	Internal Span (mm)
	0.35	0.40	1330	1700	1900	2200
0.40	0.46	1500	1800	2100	2500	
0.42	0.48	1700	2100	2200	2600	
0.48	0.53	2700	2700	2600	2700	

- Based on dead load 0.1kN/m², live load 0.25kN/m², wind load 0.75kN/m².

JET RIB	RECOMMENDED MAXIMUM ROOF LENGTH (M) ***			
	SLOPE IN DEGREE	3°	5°	7°
		RAINFALL (mm/h)		
	150	73	88	100
	200	55	66	75
250	44	52	60	
300	36	44	50	

- The amount of water that must be shed increases with the length of the roof. To avoid possible back-up of water in severe wind conditions, the following recommended roof length should be considered as maximum for a given roof pitch and rain fall rate.

*** All thickness shown above is nominal & provisional. The information contained herein is factual and numerical value are accurate at time of publication and subject to actual site condition.



Factory, Melaka



Semi Detached Factory, Bukit Raja



AJIYA STANDARD CAPPING / FLASHING

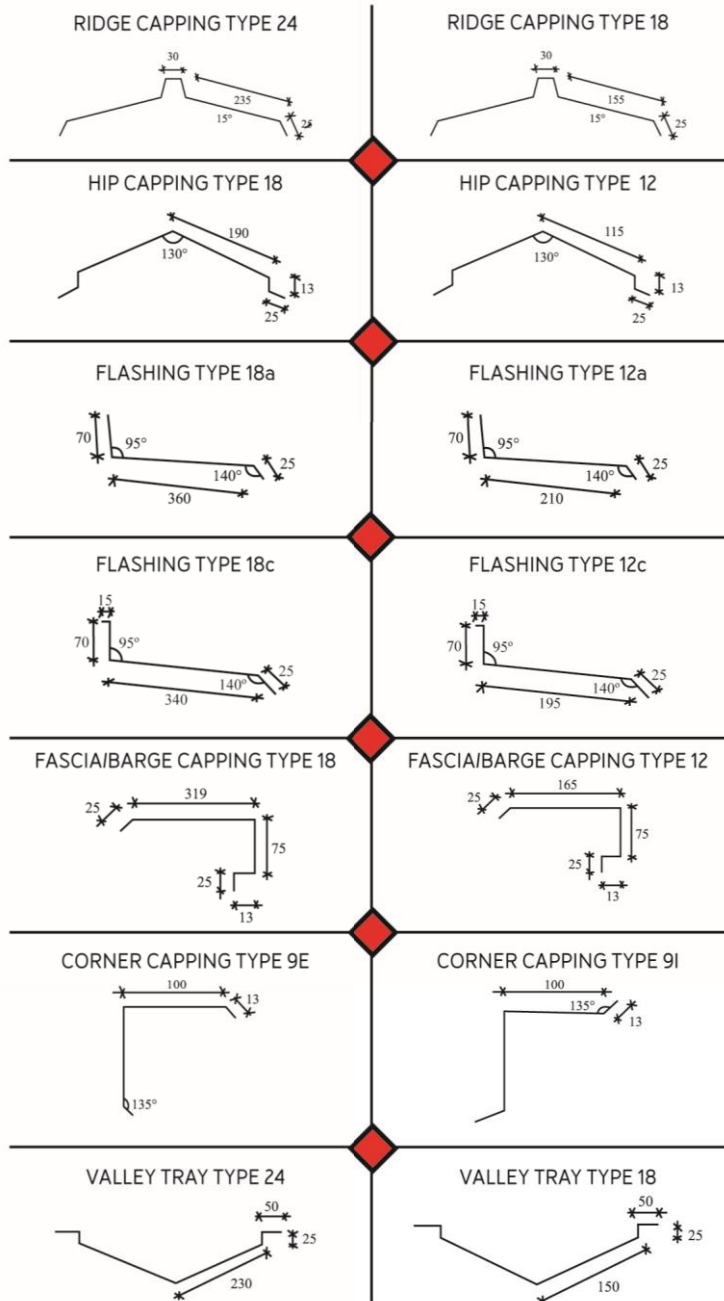

COLOR SELECTION CHART



AJIYA Colour Chart



PrimaMaju Colour Chart



CEP Colour Chart



CCB Colour Chart

Note:

Colours printed in this brochure are as close as normal printing process would allow and customers are advised to check and verify your chosen colour against an actual sample of the product before purchasing.

Other colours and thickness available upon request. Subject to stock availability and time delivery. All colours shown above are close to the actual steel colour as the limitation of the actual colour tones.

Corporate Head Office & Factory
 Lot 153, Kawasan Perindustrian
 Jalan Genuang, 85000 Segamat,
 Johor.
 Tel : +607-943 4211
 Fax : +607-943 1054
 Email: enquiry@ajiya.com

Marketing HQ & Factory
 No. 4, Jalan Sg Pelubung 32/149
 Seksyen 32, 40460 Shah Alam,
 Selangor.
 Tel : +603-5121 0011
 Fax : +603-5121 0111

Southern Marketing Office & Factory
 Lot 7068, Jalan Seelong,
 Kampung Maju Jaya,
 81300 Johor Bahru, Johor.
 Tel : +607-557 3733
 Fax : +607-556 5733

Mentakab Marketing Office & Factory
 No.11, Jalan Industri 3/5,
 Taman Perindustrian Temerloh,
 28400 Mentakab, Pahang.
 Tel : +609-270 1313
 Fax : +609-270 1311

Related Companies

ARI UTARA SDN BHD (273092-U)
 Lot 28, Taman Perindustrian
 Bukit Makmur, 08000 Sungai Petani,
 Kedah.
 Tel : +604-442 2899
 Fax : +604-442 2799

Subsidiary Companies

ARI TIMUR (KB) SDN BHD (714587-K)
 Lot 1306, Kawasan Perindustrian
 Pengkalan Chepa II,
 16100 Kota Bharu, Kelantan.
 Tel : +609-774 5946
 Fax : +609-774 6946



www.ajiya.com

The information and illustration contained herein are for guidance only. Care has been taken to ensure all data and information herein is factual and numerical values are accurate at the time of publication. However, any or all technical specification, information and dimensions are nominal and provisional; they are subjected to change and variations in accordance with market conditions at the date of factual supply. No representation is made or to be implied as to the data and information herein; Asia Roofing Industries Sdn. Bhd. and its subsidiary and associate companies shall not be responsible for any errors in or misrepresentation of the information contained in this brochure or its use. Asia Roofing Industries Sdn. Bhd. and its subsidiary and associate companies reserve the right to alter any or all specifications as deemed fit and necessary without prior notice.

Copyright © 2023 by Asia Roofing Industries Sdn. Bhd. All rights reserved.

2nd Edition

November 2023